

# algeco®



# Moduflex®

Complete site solutions in a single building

# Who We Are

We are Algeco. The market-leading UK provider of modular and portable space solutions.

## **Our purpose**

Together, we build sustainable futures.

## **Almost 60 years of hire solutions**

We've been helping organisations solve their temporary space challenges quickly, easily and cost-effectively for 60 years.



# Why Algeco?

Save time, hassle, and expense managing multiple suppliers. Our hire products are available instantly nationwide, with quick, hassle-free installation.



## Turnkey Solutions

Our turn-key services provide all the exterior and interior facilities you need for your project through one point of contact.



## Best Value

Through economies of scale, our products and services balance quality to offer you the best value possible.



## Availability

With over 40,000 portable and modular units for rent in the UK, we have the best product availability on the market.



## UK-Wide Service

With locations throughout the UK, we can deliver and install your portable buildings directly to your site, no matter where you are.



## On time, on budget? How good are we? Ask our customers.

We ask after every project how well we've done and use the Net Promoter Score system to understand satisfaction. Our latest results are scored as Excellent.









# Strength in Depth

## Algeco is part of the Modulaire Group

Europe & Asia Pacific's leading business service company specialising in modular space.

-  25 countries in Europe and Asia Pacific
-  6,000 employees in 250 locations
-  250,000 units with fleet net book value >\$3Bn

## Algeco UK Limited

-  1,200 Employees in 23 locations providing over 40,000 units
-  Huge product range from containers to multi-storey buildings
-  Two assembly factories in Cannock and Carnaby
-  20 branches covering the whole of the UK in three regions







# Turnkey Solutions

### Complete site set up through one point of contact

Building structures are only part of Algeco hire solutions. Our one-stop-shop provides all the interior and exterior details of your temporary building hire, installed and ready to go.

### Whole solutions, not just building shells

Avoid juggling multiple suppliers, purchase orders and invoices. Arrange everything from fencing and furniture to fire safety equipment and white goods before your accommodation arrives.

We can even supply Wi-Fi data, display your branding on the outside of your building and keep consumables like hand sanitiser stocked up.

### Make life easier

Sourcing everything you need from one provider means you and your teams can get to work faster with less hassle. It also means you spend less time coordinating and communicating with suppliers, which results in fewer moving parts on-site.







Here's a selection of interior and exterior products and services we can include with your temporary accommodation.

- **Anti-Vandal Secure Storage**
- **Branding**
- **Catering Equipment & Commercial Kitchens**
- **Climate Control Systems**
- **COVID-19 Hygiene Solutions**
- **Easyflo Water Bowsers**
- **Effluent Tanks**
- **Fencing & Barriers**
- **Fire Safety Equipment**
- **First Aid Kits**
- **Fuel Boxes**
- **Furniture Hire**
- **Generators & Extra Time Package**
- **Jackpad Foundations**
- **Security Lockers**
- **Service Connections**
- **Smoking Shelters**
- **Steps, Staircases & Ramps**
- **Storage Container Accessories**
- **Washroom Consumables**
- **White Goods**
- **Wi-Fi Data**



# Introducing Moduflex®

Moduflex® is the market-leading modular building system purpose-designed for temporary use, available in a wide range of applications.



## Welfare facilities

A host of welfare facilities including commercial kitchens, canteens, changing rooms, toilets and showers to complement your office accommodation.



## Light, bright & airy

At 2.5 metres tall, Moduflex® has a higher internal ceiling than most equivalent building systems, creating a bright and airy environment filled with natural light.



## Total flexibility

Our patented design can be stacked and linked to create large, open spaces up to three storeys high. Variable wall, window, and door panels remove easily and completely, to create different layout configurations with minimal restrictions.



## Quick & easy installation

Install requires minimal planning permission and groundworks, unlike traditional semi-permanent modular systems. This means less hassle, fewer disruptions, and better health and safety for everyone on site.



## Easy maintenance

The all-steel external and internal construction is robust, easy to clean and simple to repair should something go wrong.



## Safe & secure

Internally-operated integral window roller shutters promote a more secure and private environment, day and night.

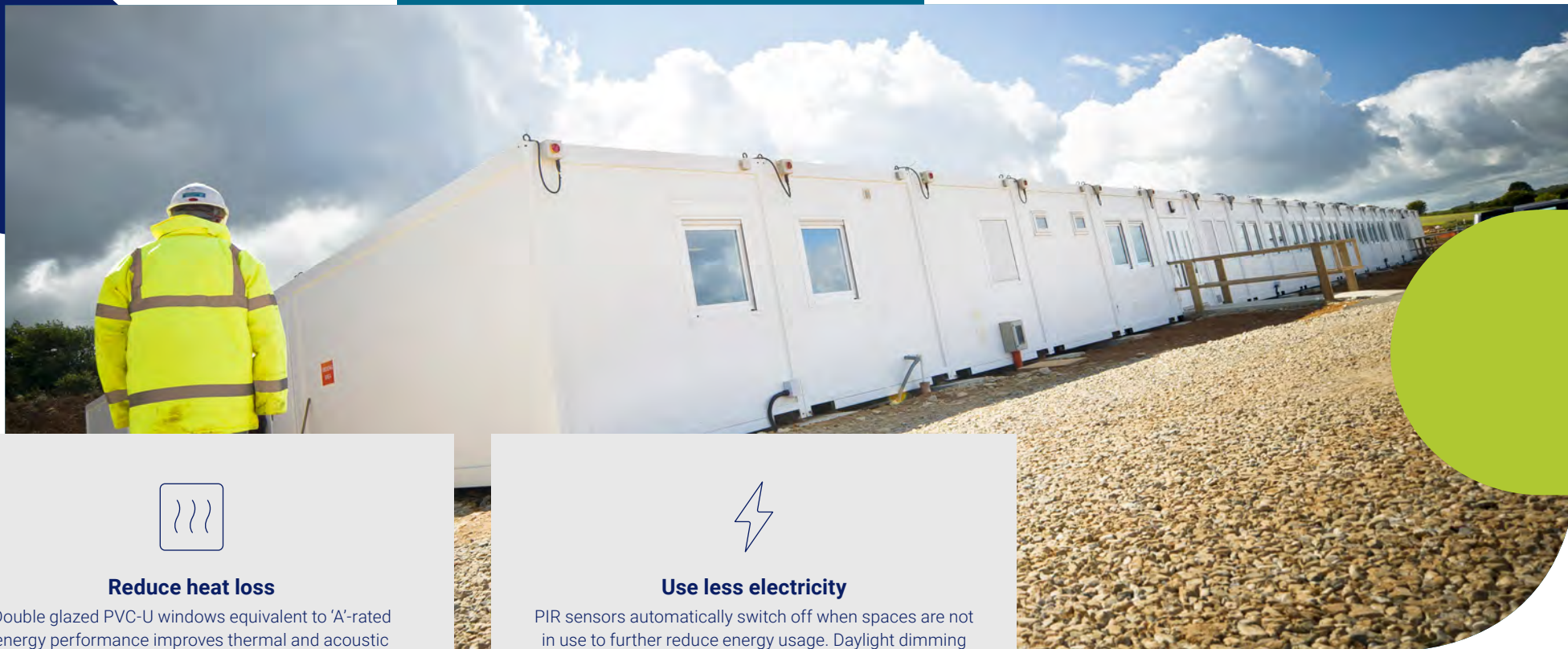

#### Reduce heat loss

Double glazed PVC-U windows equivalent to 'A'-rated energy performance improves thermal and acoustic insulation. It also reduces heat loss and cold drafts to create a warm, comfortable environment.



#### Use less electricity

PIR sensors automatically switch off when spaces are not in use to further reduce energy usage. Daylight dimming LED lighting is also available.



#### Save water

Waterless urinals, non-concussive taps with flow restrictors, and dual flush toilets reduce unnecessary water consumption.



#### Responsibly made

Moduflex® is made using responsibly sourced, recycled PVC-U and recyclable timber sourced from certified/managed forests.



#### Smart energy usage

Time-controlled heating and instantaneous water heaters reduce energy consumption without compromising warmth and comfort.



# Moduflex® Layouts

Moduflex® is a fully modular solution. This allows you to create many different designs and layouts for a wide range of applications. Here's a selection of our popular configurations.



# Type A

## Overview

- 8 Bay Complex
- Open Office (for circa 8 people)
- 24/48 Person Welfare
- Meeting Room
- Drying Facilities
- Shower Facilities

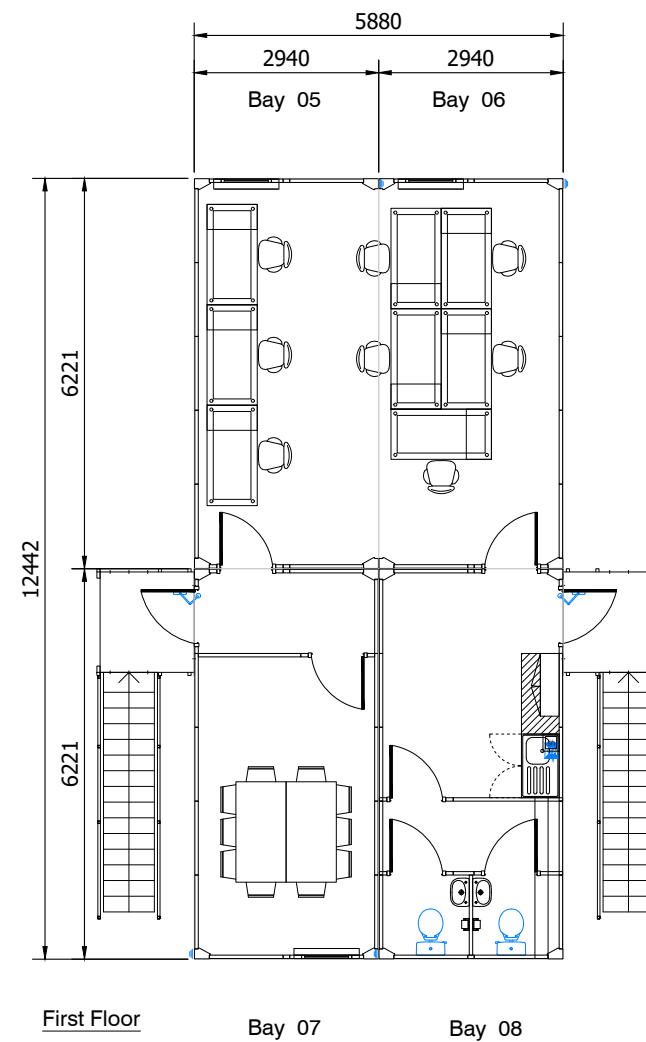
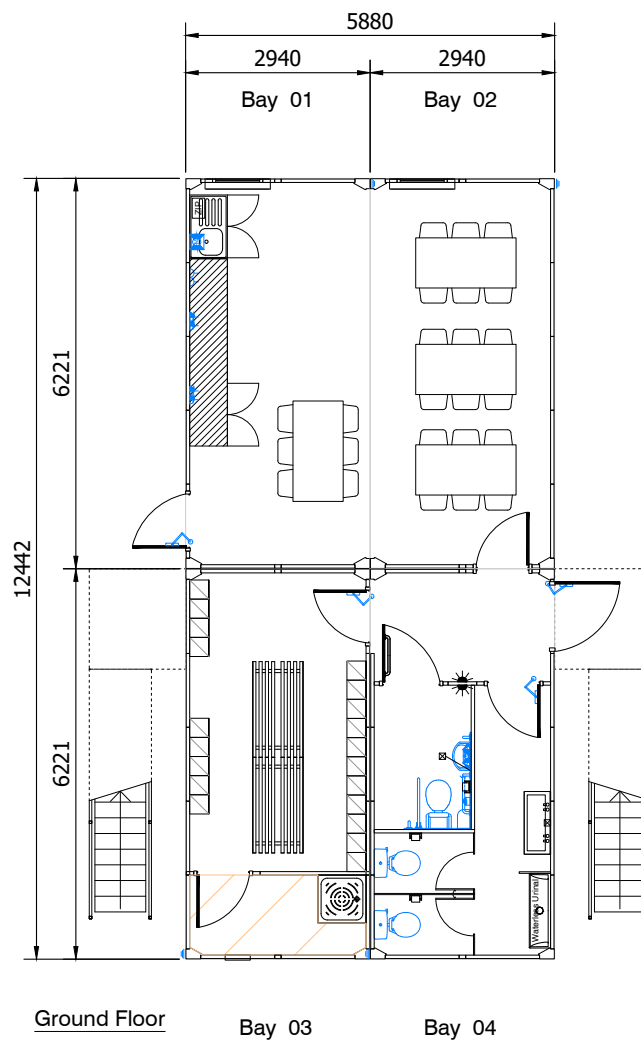

# Type B

## Overview

- 12 Bay Complex
- Open Office (for circa 10 people)
- 48–84 Person Welfare
- Meeting Room (to suit max 10 people)
- Drying Facilities
- Shower Facilities

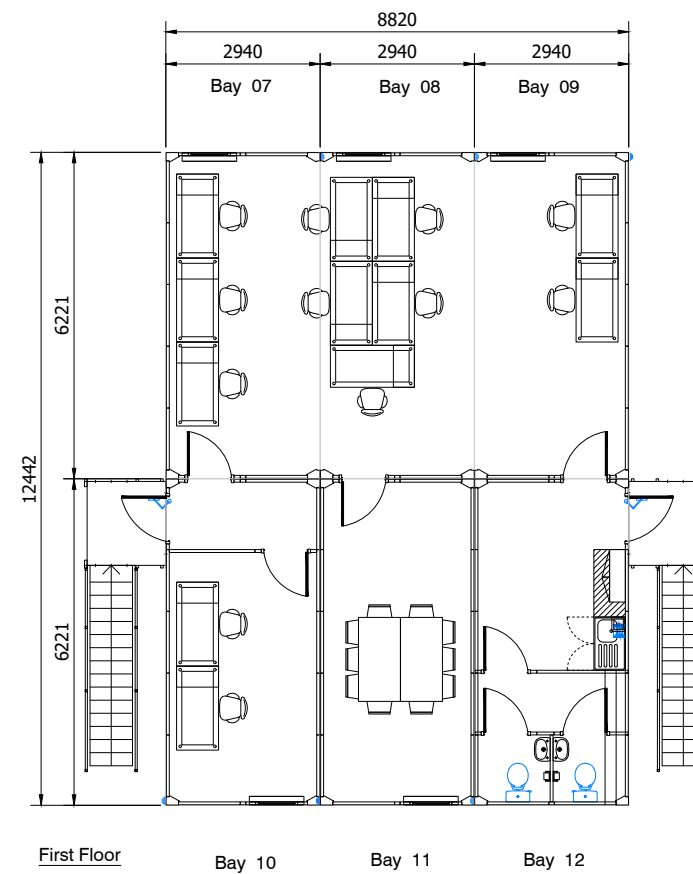
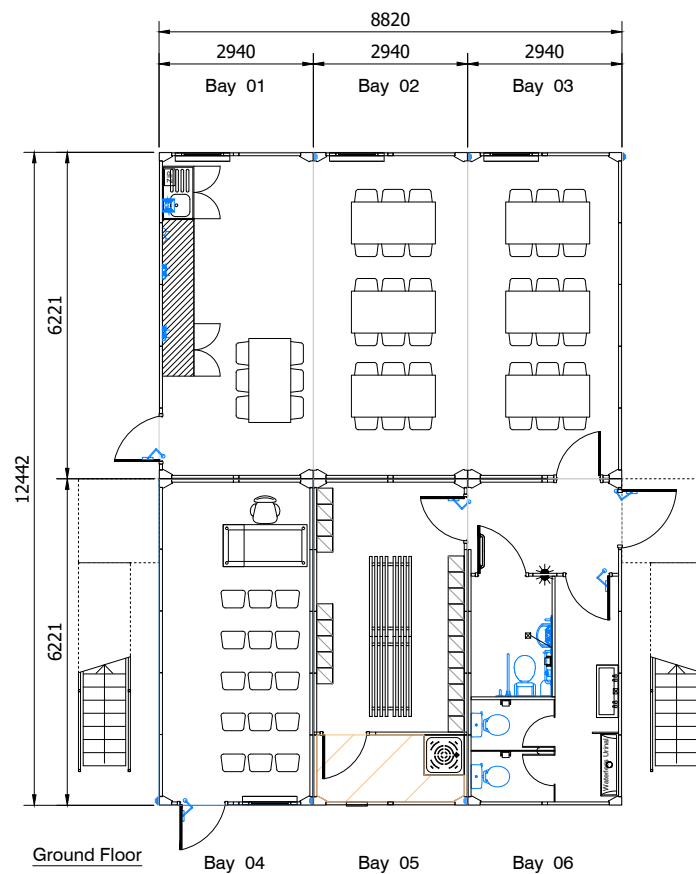

# Type C

## Overview

- 16 Bay Complex
- Open Office (for circa 15 people)
- 60–120 Person Welfare
- Large Meeting Room (to suit max 20 people)
- Drying Facilities
- Shower Facilities

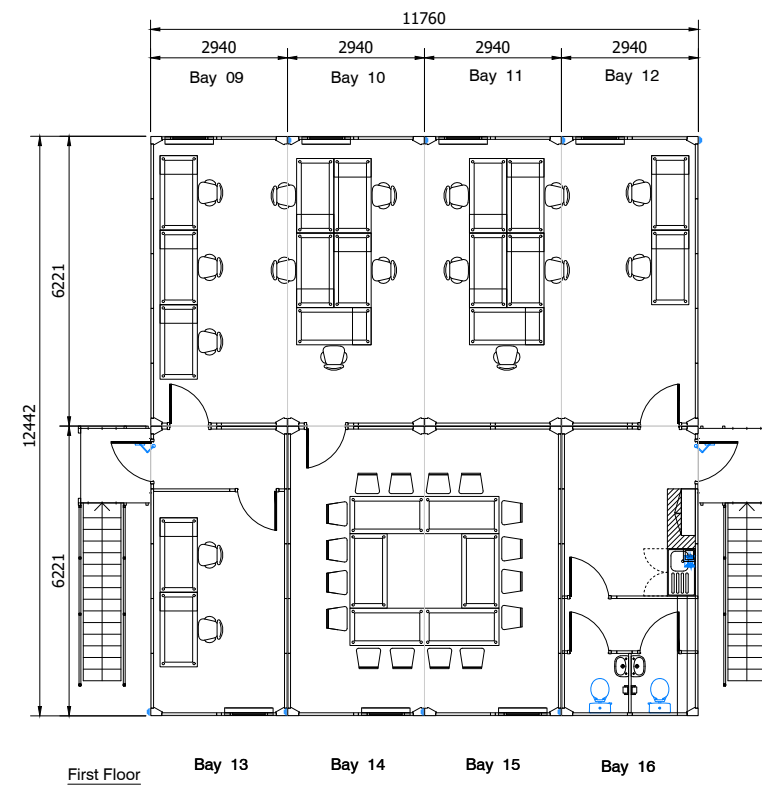
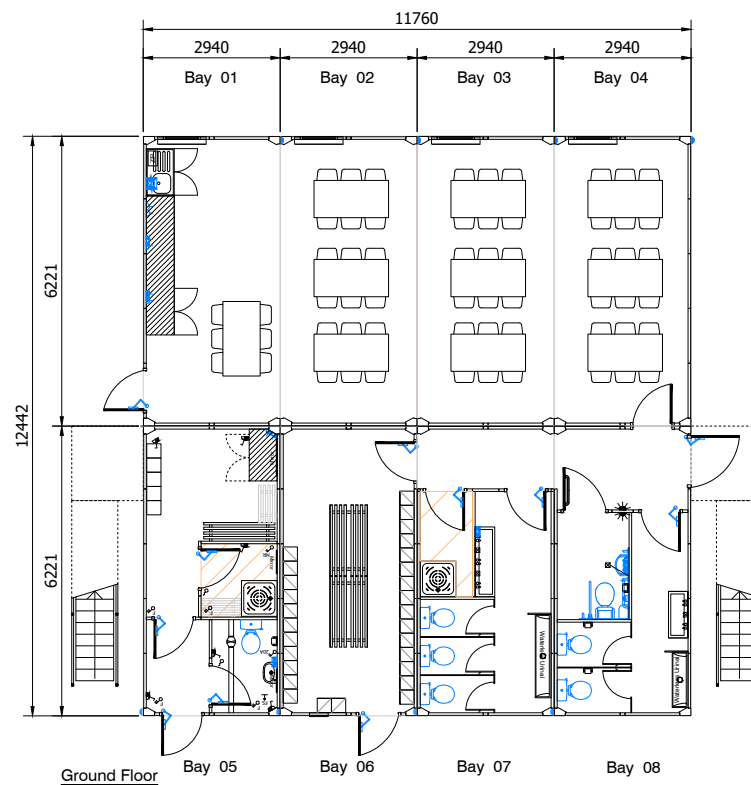



# Type D

## Overview

- 20 Bay Complex
- Open Office (for circa 20 people)
- 78–156 Person Welfare
- Large Meeting Room (to suit max 20 people)
- Small Meeting Room (to suit max 12 people)
- Drying Facilities
- Shower Facilities

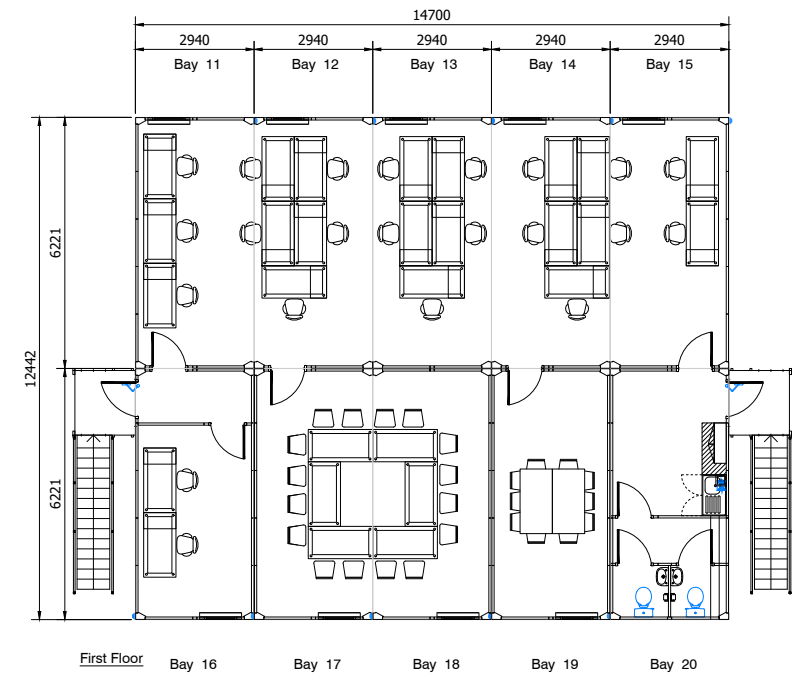
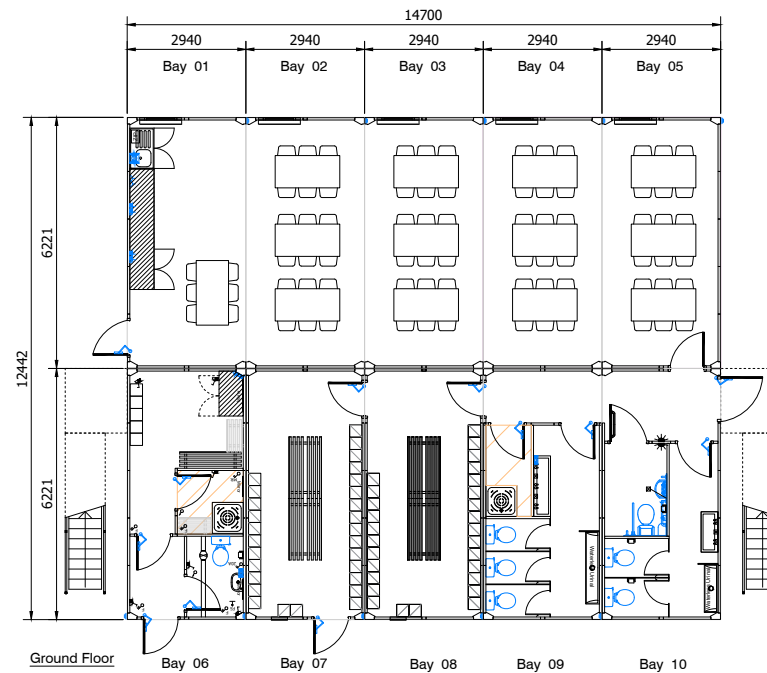

# Type E

## Overview

- 24 Bay Complex
- Open Office (for circa 22 people)
- 104–256 Operatives
- Large Meeting Room (to suit max 20 people)
- Small Meeting Room (to suit max 12 people)
- Drying Facilities
- Shower Facilities

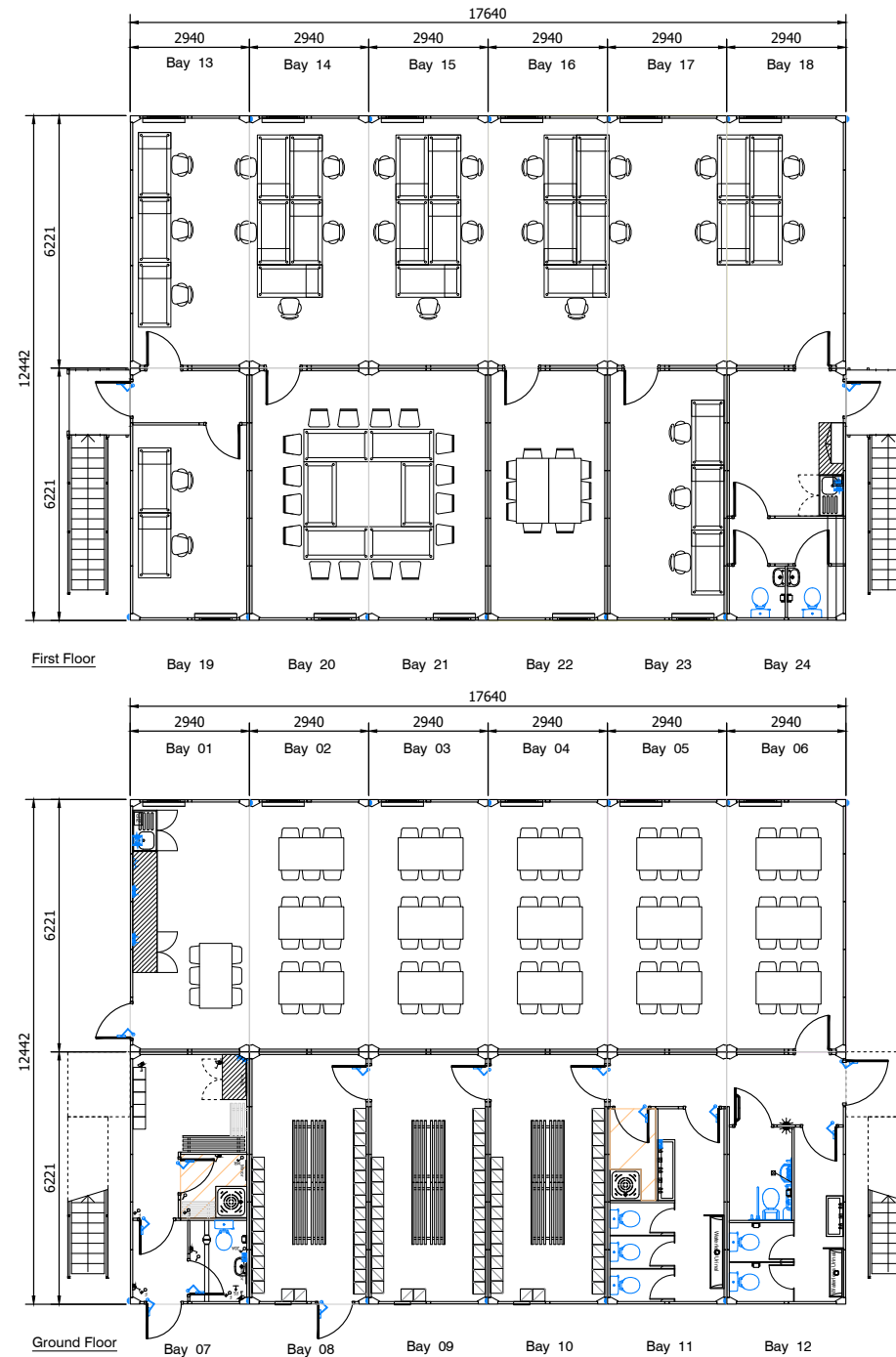

# Type F

## Overview

- 28 Bay Complex
- Open Office (for circa 27 people)
- 96–192 Person Welfare
- Large Meeting Rooms (to suit max 20 people each)
- Drying Facilities
- Shower Facilities

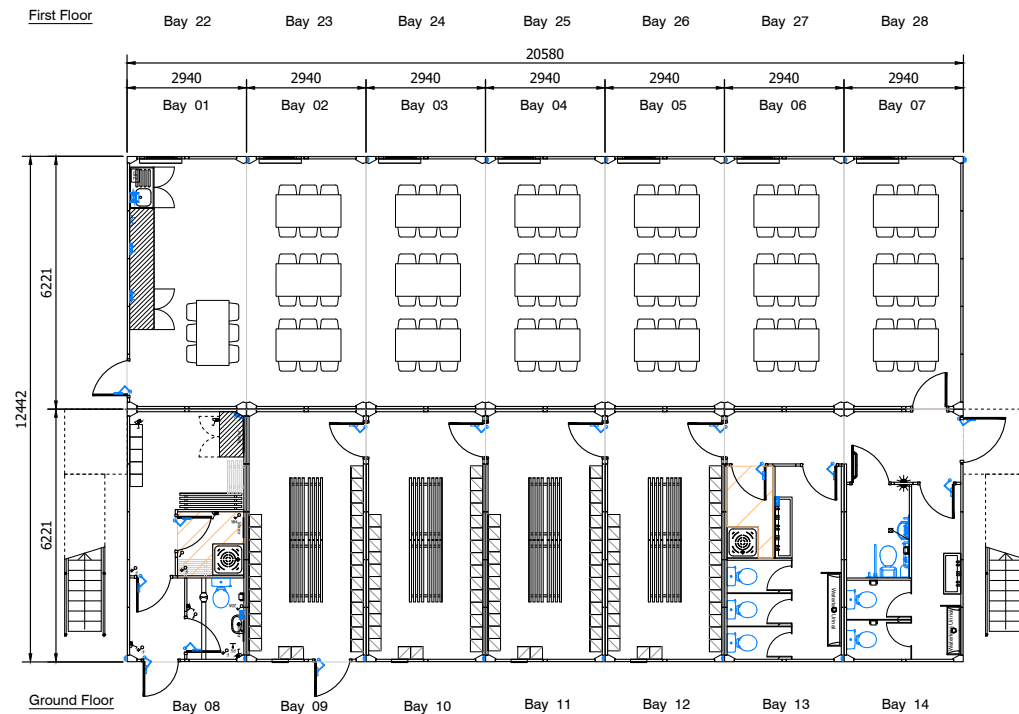
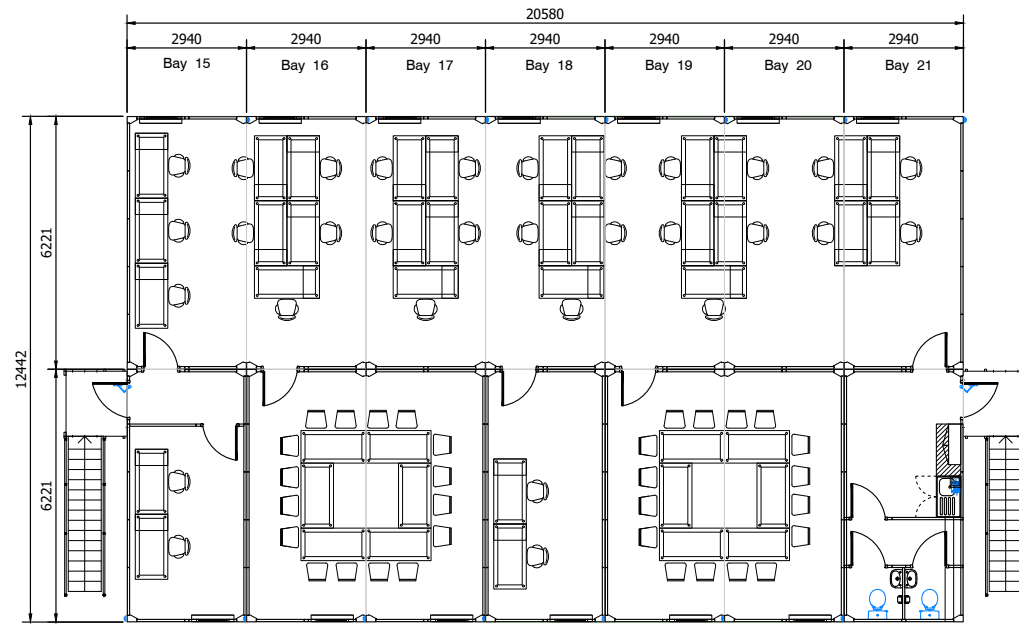



# Type G

## Overview

- 36 Bay Complex
- Open Office (for circa 50 people)
- 84–168 Person Welfare
- Large Meeting Rooms (to suit max 20 people each)
- Small Meeting Room (to suit max 12 people)
- Drying Facilities
- Shower Facilities



# Type H

## Overview

- 36 Bay Complex
- Open Office (for circa 50 people)
- 96–192 Person Welfare
- Large Meeting Room (to suit max 20 people)
- Small Meeting Room (to suit max 12 people)
- Drying Facilities
- Shower Facilities

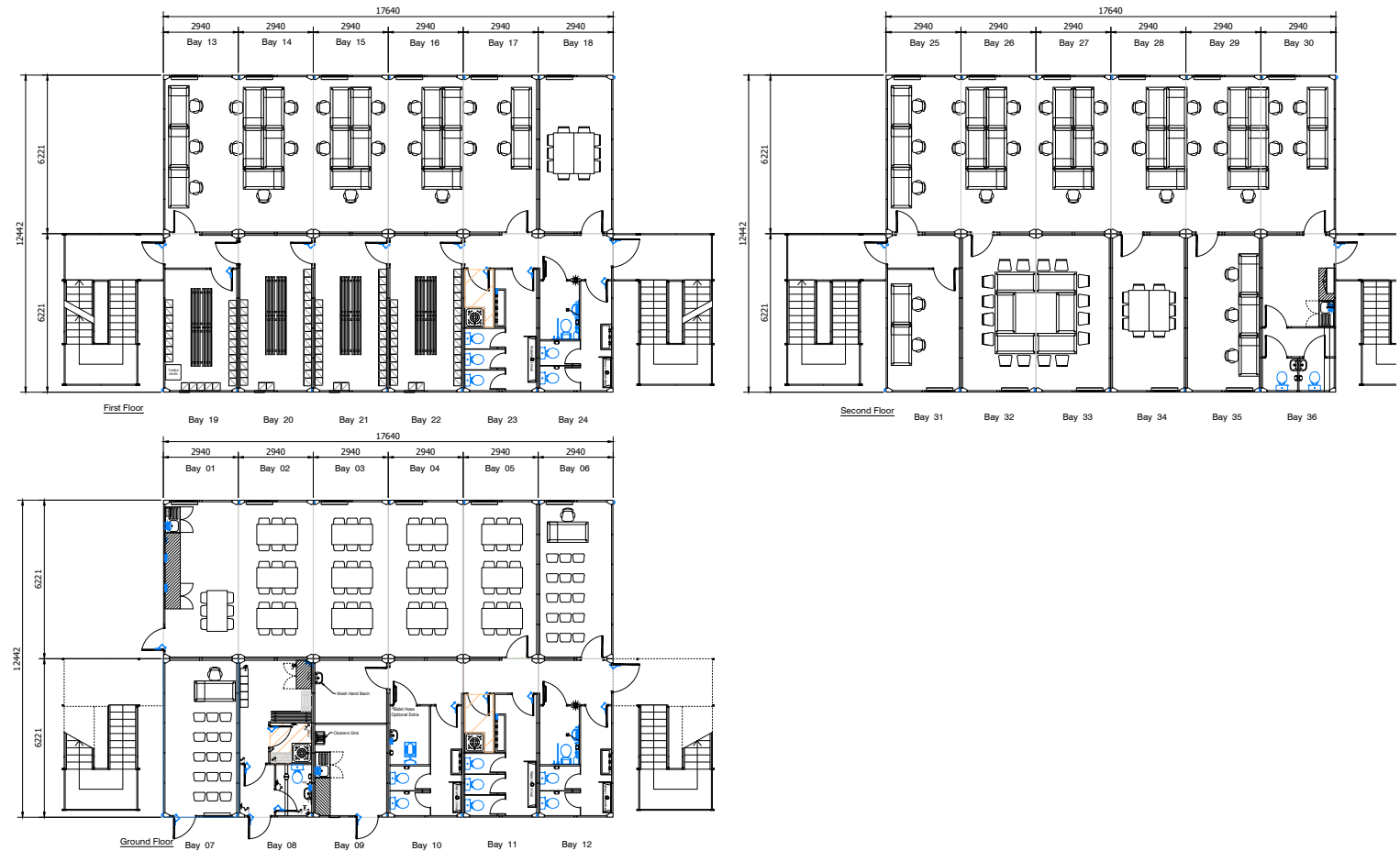

# Type I

## Overview

- 42 Bay Complex
- Open Office (for circa 54 people)
- 96–192 Person Welfare
- Large Meeting Rooms (to suit max 20 people each)
- Small Meeting Room (to suit max 12 people)
- Drying Facilities
- Shower Facilities



# Our Best Selling Facilities

Creating your one-stop-shop solution



## Furniture Hire

- Furniture is essential for all buildings. We offer a wide range of complete office, meeting/conference room, canteen and drying room packages, to get you up and running on day one.
- We have a choice of workstations, chair types and storage units for every application, providing quality furniture that is built to last.
- Hassle-free with no delays – Our furniture is delivered assembled and ready to go inside your building.
- Maintenance-free – Avoid problems associated with managing, storing, maintaining and disposing of furniture you purchase. We simply take it away when you no longer need it. Sorted.
- Additional options available – Include reception area furniture, space-saving tall lockers & drawers for hot-desking and job-sharing environments, hygiene screens, privacy screens and recycling bins.



## Climate Control

- Climate control systems substantially reduce CO<sub>2</sub> emissions compared to convector heaters, for better environmental sustainability.
- Lower energy consumption means you could save hundreds of £ in electricity costs every year.
- Systems optimise user comfort all year round, for improved productivity benefits.
- High (split) and low-level systems are available including servicing and maintenance.
- Low-level systems both heat and cool, can save up to 56% on energy costs\* and can be easily retro-fitted to buildings already on hire.
- Costs are lower than you think – starting at just £2.29 per week\* for a low level system.

\*Based on Algeco heating cycle comparison for an existing customer (July 2021). A copy is available on request.

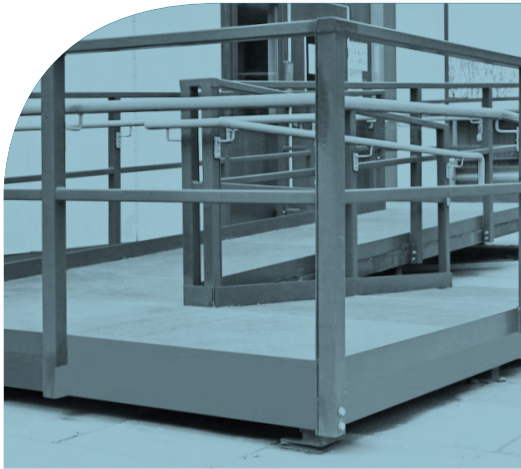

### Ramps & Steps

- Provide safe, quality and sustainable means of accessing your building, for a professional solution.
- Ensure compliance with Building Regulations Part M (Access to and use of buildings) and Part K (Protection from falling, collision and impact) by providing ramps and steps.
- Quality modular ramps – Are needed for public access buildings. Our ramps are fully adjustable and made of steel for robustness, durability and non-combustibility. Configurations are customised to your site conditions and installed rapidly. Ramps can be modified, adapted, removed and re-used for a fully flexible, sustainable solution.
- Quality modular steps – Most commonly specified for site accommodation applications and as entry-level access solutions. Fully adjustable and made from steel for non-combustibility.
- Sustainable and cost-effective recycled plastic options are also available.
- Full service included – Site surveys (where required), installation and removal.



### Fire Protection

- The safety of everyone on site should be the first priority. That includes temporary or additional buildings, which should always be fitted with fire protection equipment.
- Fire Alarms – Developed specifically for the Construction industry, we offer wireless fire points, smoke & heat detectors and base stations, all certified to relevant standards, including the Fire Protection Association Joint Code of Practice.
- Cost-effective wired fire alarms are also available.
- Fire Extinguishers – We offer the full range of options – Water (General purpose), Foam (Multi-Risk environments), Powder (Highly flammable materials) and CO2 (Electrical equipment), along with stands and mobile trolleys. Plus dedicated units for safely recycling used extinguishers.
- Our options available are suitable for use in portable, modular and traditional permanent buildings.



# Introducing Fireflex®

Fireflex® offers all the benefits of our market-leading Moduflex® temporary modular building system, with added fire-rated performance to exceed fire safety standards, and the competition.

Robust factory-engineered modules make Fireflex® the perfect temporary building solution for brownfield sites and locations with a close proximity to other buildings.



## Exceed fire safety standards

Specifically designed to provide enhanced fire protection, the structure forms a fire-rated enclosure to the module which helps operators exceed the requirements of the Joint Code of Practice (JCOP).



## 60-minute fire-rated

Each element of the building provides (from inside to out) a minimum performance of 60 minutes and provides a high level of fire protection to both the occupants of the modular structure and adjacent buildings and properties.

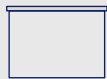

## Active fire curtain

Each opening window is fitted with active fire curtain barriers. The Vii®Fire product is a compact manual roller system tested up to 1000°C. The Fire Curtain is concealed in a steel casing above the window on the internal face. If the thermal fuse reaches 135°F/57°C, the Vii®Fire system will deploy to provide a protective barrier.



## Ideal for inner-city use

Fireflex® is 2.4m wide and ideal for restricted sites where the required 6m fire break cannot be achieved. In some cities, a movement order will not be required which saves time, cost, and makes choosing installation times/dates easier.





### 30-minute fire-rated

Roofs, walls, floors, and doors provide a level of fire rating over and above the 30 minutes integrity and insulation requested by the Joint Code of Practice (JCOP).



### Built to last

The Fireflex® building system has a design life of 50 years. The standard lacquer coated steel finish has a predicted service life of up to 20 years before its first repaint.

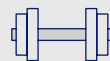

### Strong & stable

Fireflex® has been successfully assessed for its strength and stability. The building system has been assessed in accordance with Eurocode UK National Annexes in one, two and three storey configurations.







# Fireflex® Layouts

Fireflex® allows you to create many different designs and layouts for a wide range of applications. Here's a selection of popular configurations.

# Type A

## Overview

- 12 Bay Complex
- 10–12 Person Office
- 30–60 Person Welfare
- Meeting Room
- Drying Facilities
- Shower Facilities





# Type B

## Overview

- 16 Bay Complex
- 12–14 Person Office
- 42–84 Person Welfare
- Meeting Room
- Drying Facilities
- Shower Facilities



# Type C

## Overview

- 20 Bay Complex
- 16 Person Office
- 66–132 Person Welfare
- Meeting Room
- Drying Facilities
- Shower Facilities



# Type D

## Overview

- 32 Bay Complex
- 20 Person Office
- 78–156 Person Welfare
- Meeting Room
- Drying Facilities
- Shower Facilities

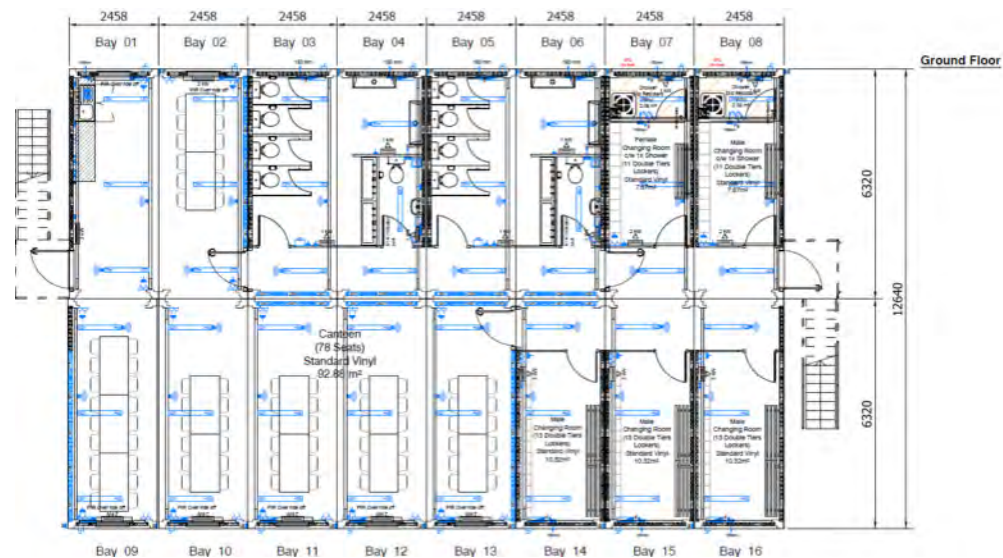
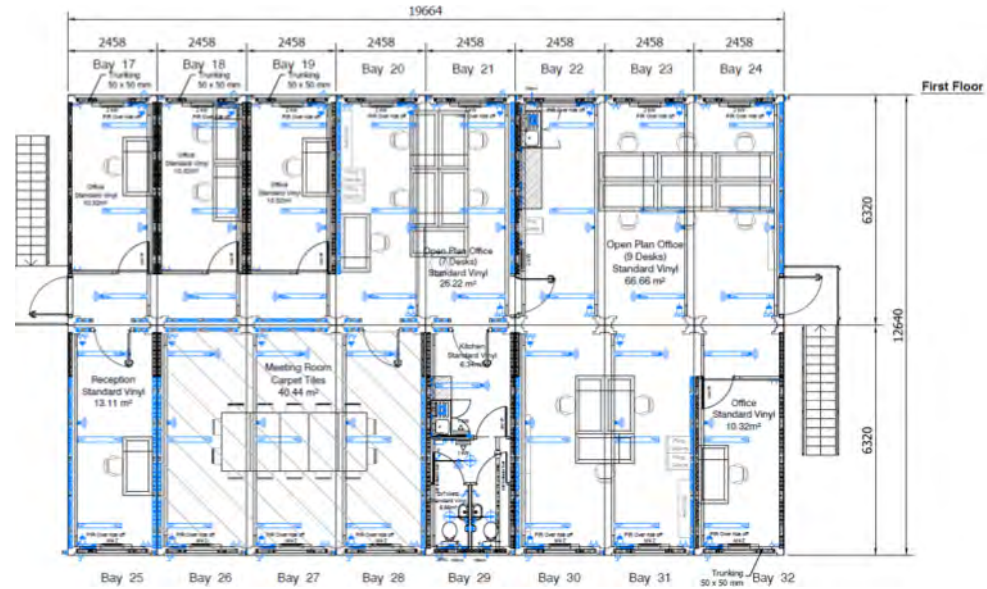





# Sustainability

Algeco is committed to sustainable development. The UN Sustainable Development Goals provide a shared blueprint for peace and prosperity for people and the planet, now and into the future. Here's how we're meeting them.



## SDG 12 – Responsible Consumption & Production

Goal: Ensure sustainable consumption and production patterns.

Our sustainability roadmap details plans to switch to renewable and sustainable energy sources, offset carbon, and enhance our circular economic activities through leasing, re-deploying and end-of-life recycling.

## SDG 9 – Industry, Innovation & Infrastructure

Goal: Build resilient infrastructure, promote inclusive and sustainable industrialisation and foster innovation.

We are an EcoVadis Silver member, recognising our commitment to sustainable practices and continually improving our corporate social responsibility.

## SDG 13 – Climate Action

Goal: Take urgent action to combat climate change and its impacts.

Algeco, along with our parent company, the Modulaire Group, are committed to achieving Net Zero emissions by 2050, and helping our customers do the same.

## SDG 4 – Quality Education

Goal: Ensure inclusive and equitable quality education and promote lifelong learning opportunities for all.

We received the Investors in Young People Gold Award. We will continue this commitment to positive outcomes for young people with up to 30 apprenticeships by the end of 2021.

## SDG 5 – Gender Equality

Goal: Achieve gender equality and empower all women and girls.

We are prolific supporters of Women in Construction, half our workforce composed of women working throughout the company.

## SDG 11 – Sustainable Cities & Communities

Goal: Make cities and human settlements inclusive, safe, resilient and sustainable.

We are a Partner and Gold member of the Supply Chain Sustainability School, demonstrating our active participation in the school to increase our sustainability knowledge and competence.



# Monitoring our Progress

## Our 2025 sustainability and ESG commitments

To deliver on our focus areas, we have outlined the following commitments to 2025, when we will review our targets and timeframes for completion. Alongside this, we have started our ESG disclosures and have mapped our key focus areas to create an ESG dashboard to monitor our progress.

All underpinned by the TCFD, UNGC and SDGs

### 2021

#### Environmental

- Report to Board progress on Net Zero Strategy through the ESGS committee
- 4 reviews per annum
- Establish Group Operational Carbon baseline tonnes of annual Scope 1 and 2 for 2020
- Establish Group Operational Energy Intensity per Modular Space Unit based on carbon footprint
- Undertake an assessment of carbon footprint of a typical Modular Space Unit (baseline 2020)
- Roll out a Group-wide strategy to reduce or mitigate Scope 1 and 2
- Design and build New Frankfurt Branch using Best Available Technology (BAT) for sustainability to achieve BREEAM Outstanding accreditation

#### Social

- Zero fatalities
- Reduce Lost Time Incident Frequency Rate (LTIFR) per 100,000 by 15%
- Group Zero Harm Strategy rollout
- Launch Wellbeing Helpline in every SBU (6/6)
- Rollout a Group-wide Equality, Diversity & Inclusion strategy and training
- Establish Employee Retention Rate
- Establish a Voluntary Labour Turnover Rate
- Establish Involuntary Labour Turnover Rate
- Create a Talent Development Programme

#### Governance

- Rollout of Code of Ethics and Anti-Corruption Policy and related training to all employees (new starters 3 months)
- Establishment of ESG & Sustainability Committee
- ESG & Sustainability Materiality assessment – 2 reviews
- ESG & Sustainability Disclosure Practice – 2 reviews
- Sustainability & ESG, climate-related risks and opportunities – 2 reviews
- Cyber risks to be reviewed with the board at least once a year
- Rollout of Cyber Security Policy and related training (new starters 3 months grace)
- Signature of the UN Global Compact
- Group-wide strategy to support the donation and discounting of units to support local community groups

2022



## Resource Efficiency

### Environmental

- Implement Internal Climate Change and Circular Design Key Principles Protocols for new modular space unit designs
- Greening of Supply Chain and ESG Protocols for Suppliers
- Establish Climate Adaptation Plans for each SBU
- Biodiversity Impacts Protocols for Modulaire sites
- Frankfurt Branch assessment for BREEAM
- Establish Group Operational Carbon baseline tonnes of annual Scope 3 for 2021
- Establish Science Based Targets

### Social

- Paid Voluntary Time – 5,000 hrs pa.
- Completion of a global employee satisfaction survey
- Develop a Graduate Programme in all SBUs
- Group participate and undertake three UN Days: March 8th – International Women's Day; April 28th – World Day for Safety and Health at Work; October 10th – World Mental Health Day

### Governance

- Commence group-wide Supply Chain audit for modern day slavery
- All design and assembly facilities to achieve ISO 14001/ ISO 9001
- Cyber risks to be reviewed with the board at least once a year
- Rollout of Cyber Security Policy and related training (new starters 3 months grace)
- Signature of the UN Global Compact
- Group-wide strategy to support the donation and discounting of units to support local community groups

2023



## Low Carbon Solutions

### Environmental

- Source 100 % Renewable Electricity for the Group where available
- Roll out a Group-wide strategy to reduce or mitigate Scope 3

### Social

- Increase overall female participation at Board and Senior Management level
- Increase overall proportion of female employees
- Map gender wage gap for all SBUs
- Paid Voluntary Time – 7500 hrs pa.
- Group participate and undertake three UN: March 21st – International Day for the Elimination of Racial Discrimination;
- June 5th – World Environment Day; December 10th – Human Rights Day

2024

## Social

- Paid Voluntary Time – 10,000 hrs pa.

### Governance

- Increase number of locations with Management Systems e.g. ISO 14001/ISO 9001



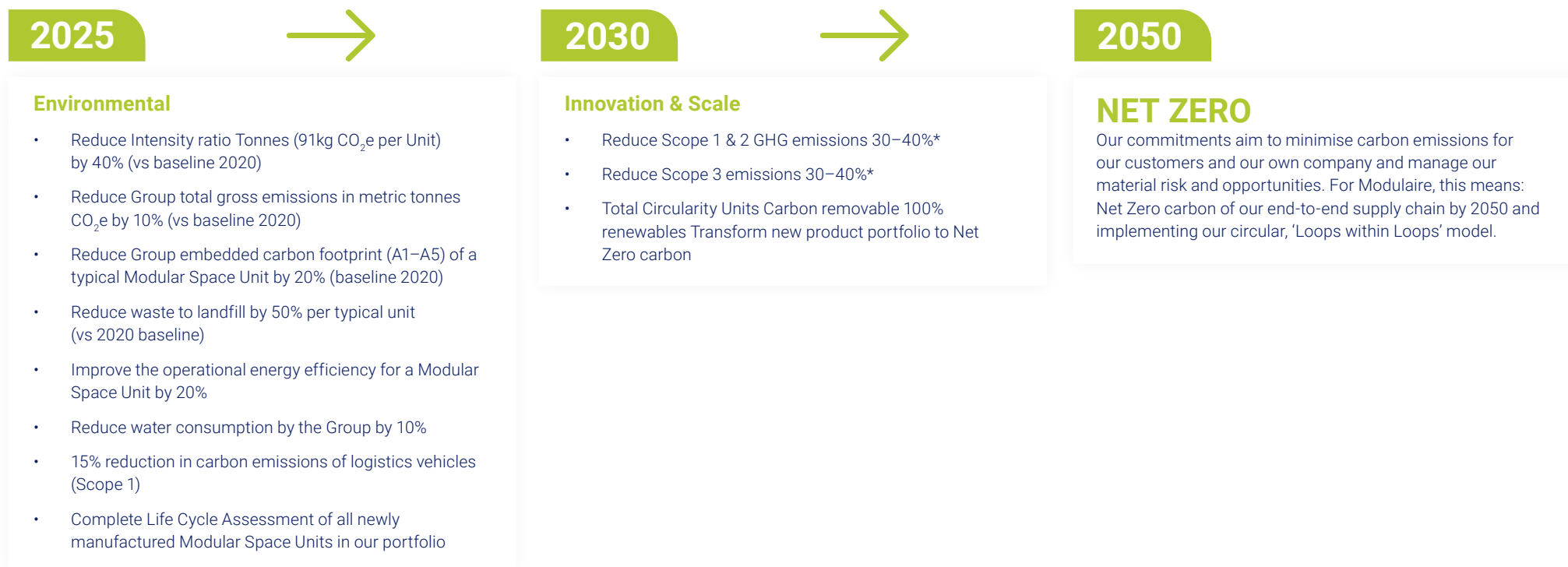

## Modulaire Path to Net Zero

From a 2020 emissions base line:  
Modulaire path to Net Zero by 2050

Reduce scope 1 and 2 GHG emissions 30–40% by 2030

Reduce scope 3 emissions 30–40% by 2030

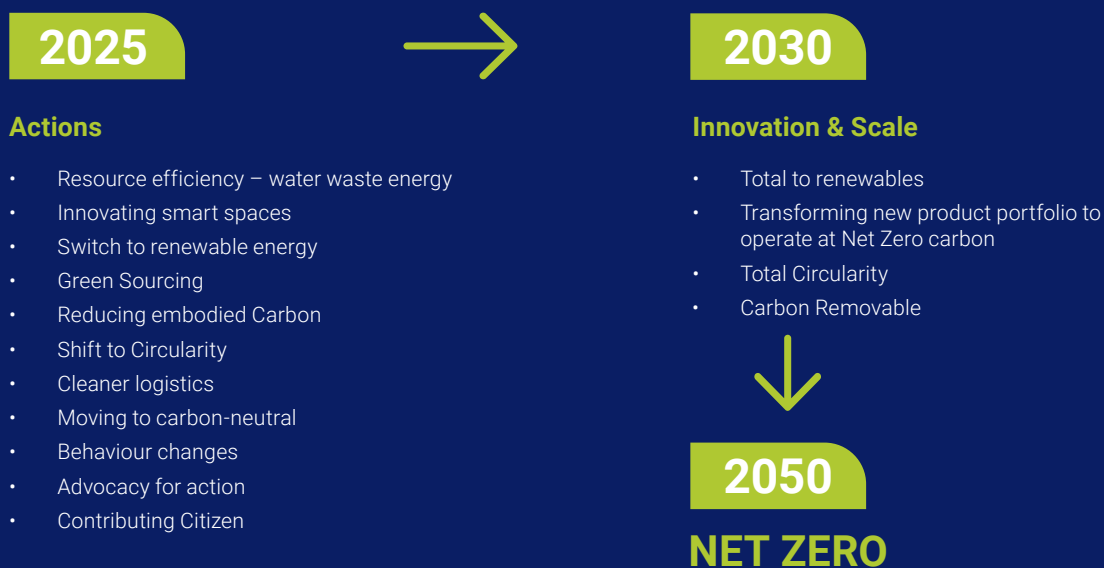



# Technical Data

Description	6m Moduflex®	9m Moduflex®	Fireflex®
Module Dimensions (W x L x H)	2930 <sup>†</sup> x 6211mm x 2900mm (20ft x 10ft x 10ft)*	2930 <sup>†</sup> x 8220mm x 2900mm (30ft x 10ft x 10ft)*	2442 <sup>††</sup> x 6320mm x 2940mm (20ft x 10ft x 10ft)
Weight **	2500kg	3200kg	3000kg
Triple-stacking capability	✓		✓
Turn-key solutions available	✓	✓	✓
Meets section 13 of Fire Prevention on Construction Sites JCOP (9th Edition)			✓
Typical EPC Rating***	C–D	C–D	B–C
Wall Panels			
Structure	55mm composite	55mm composite	100mm sandwich panels
Insulation	55mm polyurethane insulation	55mm polyurethane insulation	Mineral wool density 100kg/m <sup>3</sup>
Inner Lining	0.45mm embossed pre finished steel inner lining	0.45mm embossed pre finished steel inner lining	Decorative inner steel sheet
Class O	✓	✓	✓
'U' Values	0.403 W/m <sup>2</sup> K	0.403 W/m <sup>2</sup> K	0.38 W/m <sup>2</sup> K
Fire Performance			92 minutes integrity/60+ minutes insulation
Internal Walls			
Class O	✓	✓	✓
Roof			
Structure	1 degree dual pitch roof. 0.5mm interlocking lacquered steel tray ceiling	1 degree dual pitch roof. 0.5mm interlocking lacquered steel tray ceiling	1 degree dual pitch roof. 0.5mm interlocking lacquered steel tray ceiling
Floor			
Structure	Steel structure – Twin longitudinal sections with transverse steel floor bearers welded and positioned at 400mm centres (Floor loading of 2.5kn/m <sup>2</sup> )	Steel structure – Twin longitudinal sections with transverse steel floor bearers welded and positioned at 400mm centres (Floor loading of 2.5kn/m <sup>2</sup> )	The floor chassis consists of side skids from bespoke cold formed profiles. The floor is decked with 19mm CTBX plywood. The floor is insulated with 2 layers 80mm mineral wool fitted between and under the structural floor (Floor loading of 2.5kn/m <sup>2</sup> )
'U' Values	0.501 W/m <sup>2</sup> K <sup>†††</sup>	0.501 W/m <sup>2</sup> K <sup>†††</sup>	0.26 W/m <sup>2</sup> K



# Fireflex®

## Raising on-site fire protection standards

Learn more about how Moduflex® and Fireflex® can promote worker wellbeing and improve productivity on your site.

 0808 108 2222

 [help@algeco.com](mailto:help@algeco.com)

 [algeco.co.uk](http://algeco.co.uk)

